



SREEVATSA URBAN VILLAGE

Choose your style



Apartments
starting
22.4 lakhs*

Apartments that you can
walk-in and start living



SREEVATSA REAL ESTATES PVT LTD
BUILDING ON THE FOUNDATION OF YOUR TRUST



Buying the right apartment is only the first step to owning a home. From Vanilla to fully furnished, acclimatizing your apartment with interiors to suit your individual preferences is what it takes to make your apartment your home. At Sreevatsa we think ahead of you; identifying your every need in ensuring that your apartment gives you superior livability with everything that you want taken care of.

So, why buy plain-jane walls and pillars when you can buy **furnished apartments** that will make your living experience a pleasure.

With the Sreevatsa stamp of quality a 'given' rest assured that only the best will go into the making of your apartment-home. No less certainly, maybe more possibly.

What you see is what you get – absolutely!

Sreevatsa Urban Village comes as single, and two BHK apartments that maximize comfort in minimum space. With all basic amenities forming part of the standard offer these apartments are an ideal fix for people who are looking for cozy, **easy to maintain homes.**

AMENITIES

- Children Play Area
- Half Basket Ball Court
- Reflexology Walking Track
- Landscaped Garden
- Lifts
- Genset Backup for Lifts & Common Area
- CCTV
- 24 X 7 Security
- Provision for RO Unit at Kitchen
- UPS Wiring for Lights, Fans & 2 Plug Points
- STP

SREEVATSA URBAN VILLAGE

Choose your style



Look around!

Sreevatsa Urban Village abuts the Sreevatsa Global Village enclave – a successful community of over 350 families comprising villas and apartment homes. But what makes it more attractive is the service and infrastructure offered by **Sreevatsa Lunchbox – a Vegetarian Central Kitchen and Party Place with lawns and food service stalls** that will give you quick-fix solutions for entertaining guests. Also, Lunchbox delivers food at your doorstep all days of the year if you are so inclined to call it a day on your culinary skills.

Go from Vanilla to fully-loaded!

Sreevatsa Urban Village apartments come in Basic, Silver, Gold & Platinum finishes with or without furnishing and trims.. While the Basic modules are living units without furnishing and accessories, the loaded modules come with levels of furnishing and paint finishes that escalate the ambience and the living experience of the apartments. The Silver modules come with a basic modular kitchen, furnishing and accessories that you would love to have in a minimally furnished apartment. The Gold standard accents finishes and trims that add to the ambience and the Platinum comes with a whole lot of things that include top-end modular kitchens, superior fixtures, wall finishes etc.

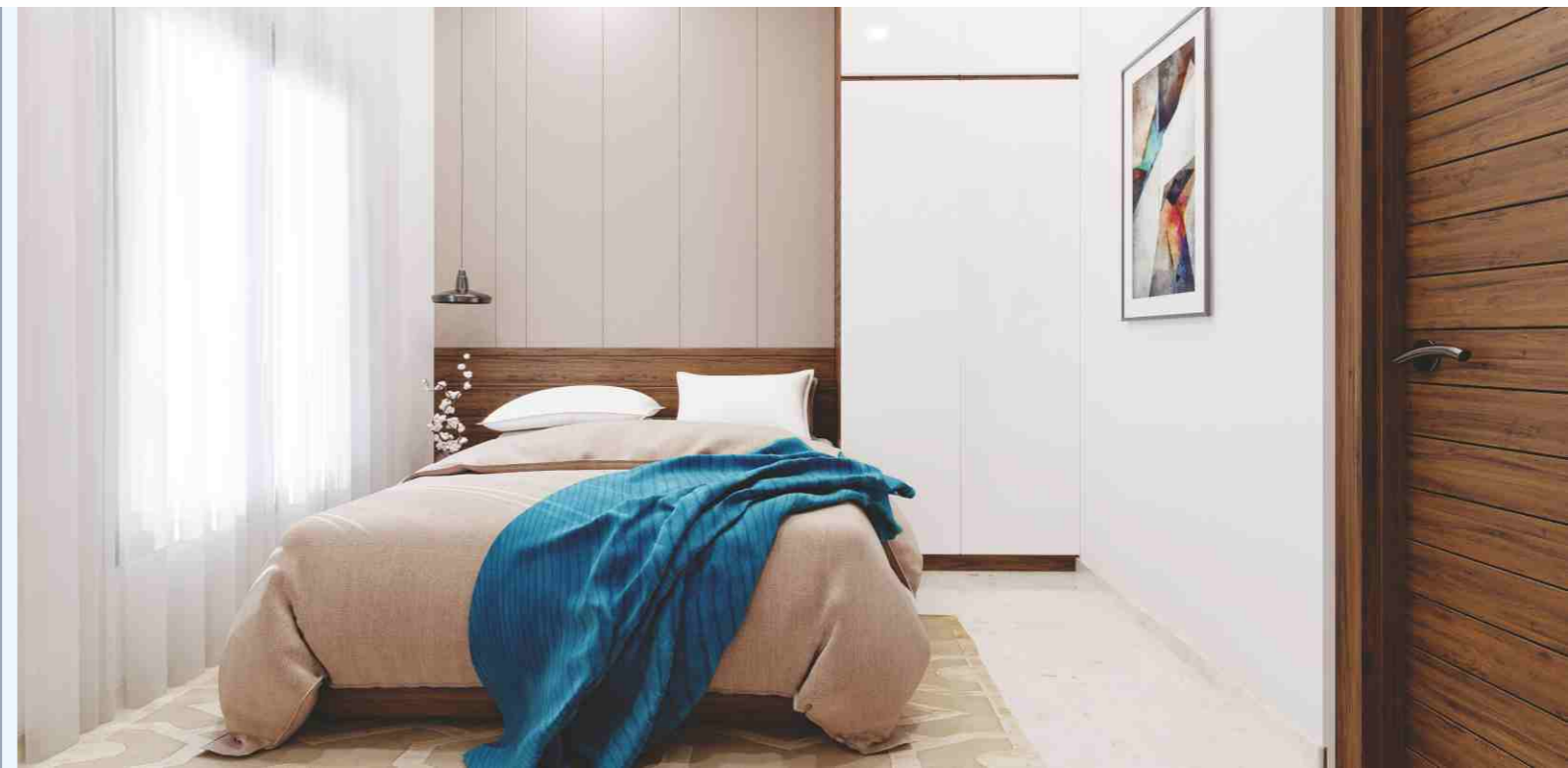

A, B & C BLOCK FLOOR PLAN



E BLOCK FLOOR PLAN

103 to 403
789 Sq.ft

104 to 404
605 Sq.ft

105 to 405
605 Sq.ft

106 to 406
605 Sq.ft

107 to 407
789 Sq.ft



102 to 402
789 Sq.ft

101 to 401
605 Sq.ft

109 to 409
605 Sq.ft

108 to 408
789 Sq.ft



SPECIFICATIONS

STRUCTURE	: RCC framed structure, solid block masonry with plastering
DOORS	
All doors	: Good quality doors
Hardware	: Stainless steel hardware fittings
WINDOWS	: UPVC Windows
FLOORING	
Floor	: Vitrified tiles
Skirting	: 3" height granite
KITCHEN & UTILITY	
Counter	: Granite top
Sink	: Stainless Steel -Single Bowl
Dado	: Ceramic tile up to 2' height from counter top
BATH ROOMS	
Floor	: Antiskid Ceramic tile
Walls	: Glazed tile up to lintel height
CP Fittings	: Towel rod, hot and cold water wall mixer and Ablution tap.
SANITARY FIXTURES & FITTINGS	
Floor mounted European closet and wash basin. Chromium plated fittings	
PLUMBING	
Internal	: Concealed UPVC pipe for cold water and CPVC pipe for hot water line.
External	: Open UPVC pipe
PAINTING	
Ceiling & Internal	
Walls	: One coat of primer applied over putty
External walls	: One coat of white cement primer and two coats of exterior Emulsion paint*
ELECTRICAL	
Single phase power supply through Individual DB and ELCB	
Wiring	: Concealed wiring with Standard IS make wires.
Switches	: Modular switches of standard IS make
	: Conduits with wiring provision for individual UPS in each flat
	: Back up power Supply for common areas and amenities
TERRACE	: Weathering course with surkhi and finished with clay tile.
SEWAGE DISPOSAL	: Common STP for the complex.
BALCONY	: MS Grill as per architect design

*All colours, shades and design shall be as per Architect's choice and approval



Silver
Gold
Platinum

1 BHK



2 BHK

Silver
Gold
Platinum

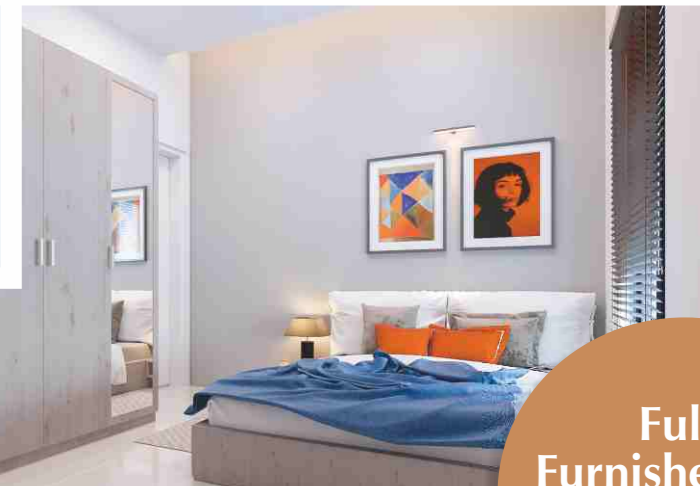

Fully
Furnished
Options
Available

Location Map

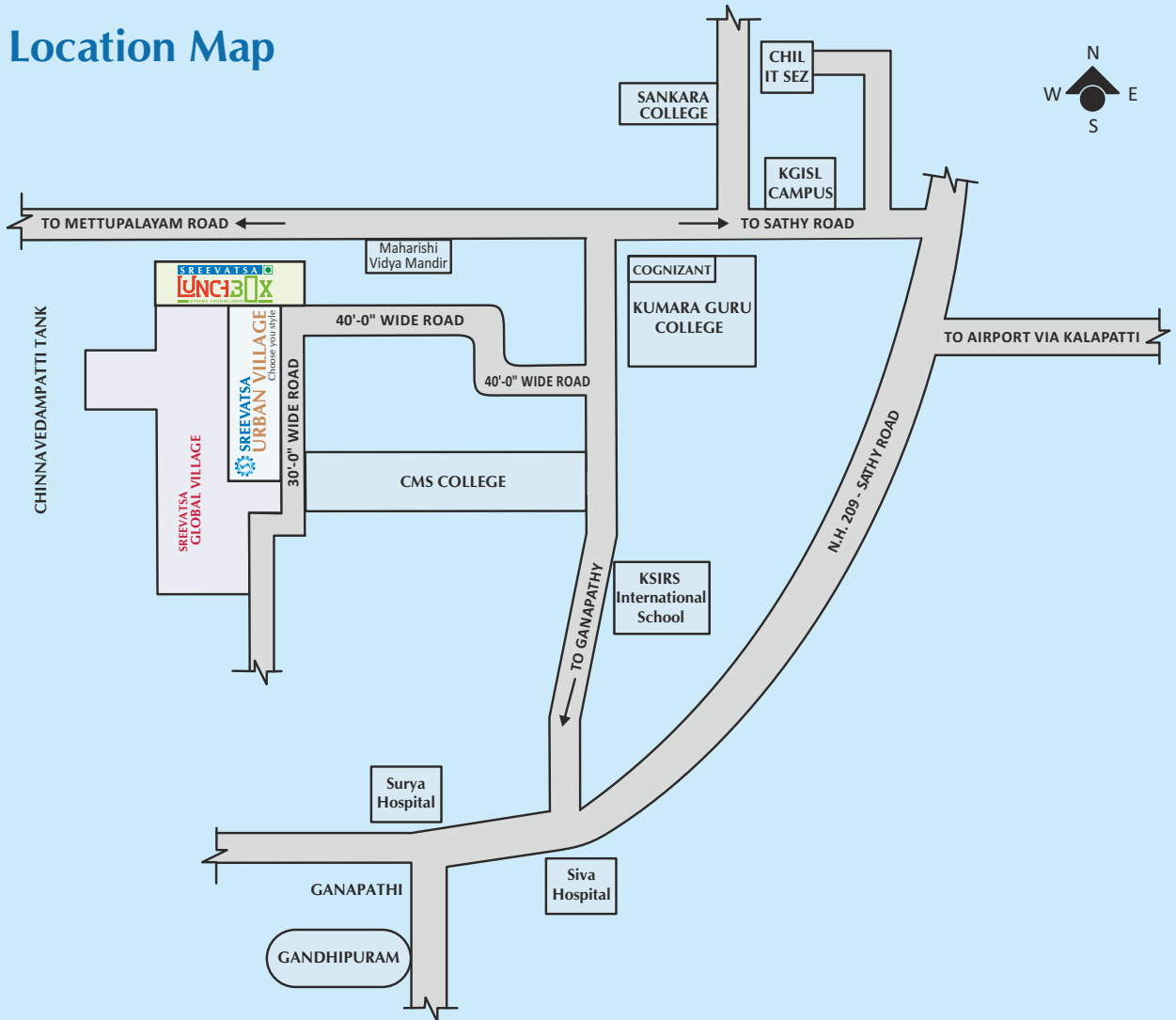

To know more call us at



SREEVATSA REAL ESTATES PVT LTD
 BUILDING ON THE FOUNDATION OF YOUR TRUST

New no. 324, Mettupalayam Road, Coimbatore - 641 043, Tamil Nadu, INDIA

Email: realestate@sreevatsa.com | www.sreevatsa.com

Member



Disclaimer: The architectural, landscape features, amenities and colour schemes of buildings are subject to change. Visual representations such as plans, finishes, illustrations, photographs and drawings contained in this document are artist's impression only and not representation of fact. Furniture shown in the plans are indicative only and do not form part of the contract. Dimensions in the plans are wall exclusive of finishes.

*Conditions apply

A, B, C BLOCK 1 BHK



101 to 401, 102 to 402, 112 to 412 & 113 to 413



Flat No.	Carpet Area in Sq.ft	Balcony Area in Sq.ft	Common Area in Sq.ft	Sale Area in Sq.ft
101 to 401	365	47	113	586
102 to 402	360	47	112	582
112 to 412	365	47	113	586
113 to 413	365	47	113	586

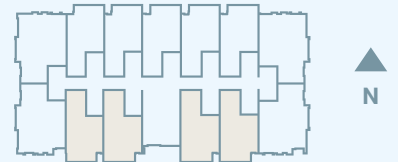

DIMENSION

- 1 - HALL / DINING - 17'0" x 8'3"
- 2 - KITCHEN - 6'0" x 8'8"
- 3 - BEDROOM - 10'0" x 11'1"
- 4 - TOILET - 10'0" x 5'6"
- 5 - BALCONY - 4' WIDE



A, B, C BLOCK 1 BHK



105 to 405, 106 to 406, 107 to 407, 108 to 408, 109 to 109



Flat No.	Carpet Area in Sq.ft	Balcony Area in Sq.ft	Common Area in Sq.ft	Sale Area in Sq.ft
105 to 405	360	47	112	582
106 to 406	365	47	113	586
107 to 407	365	47	113	586
108 to 408	365	47	113	586
109 to 109	365	47	113	586

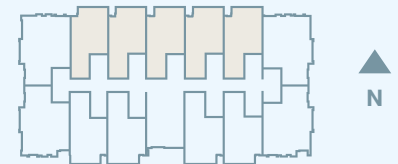

DIMENSION

- 1 - HALL / DINING - 17'0" x 8'3"
- 2 - KITCHEN - 6'0" x 8'8"
- 3 - BEDROOM - 10'0" x 11'1"
- 4 - TOILET - 10'0" x 5'6"
- 5 - BALCONY - 4' WIDE



A, B, C BLOCK 2 BHK

103 to 403

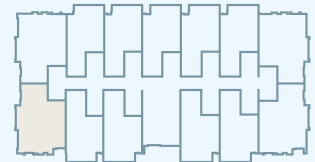
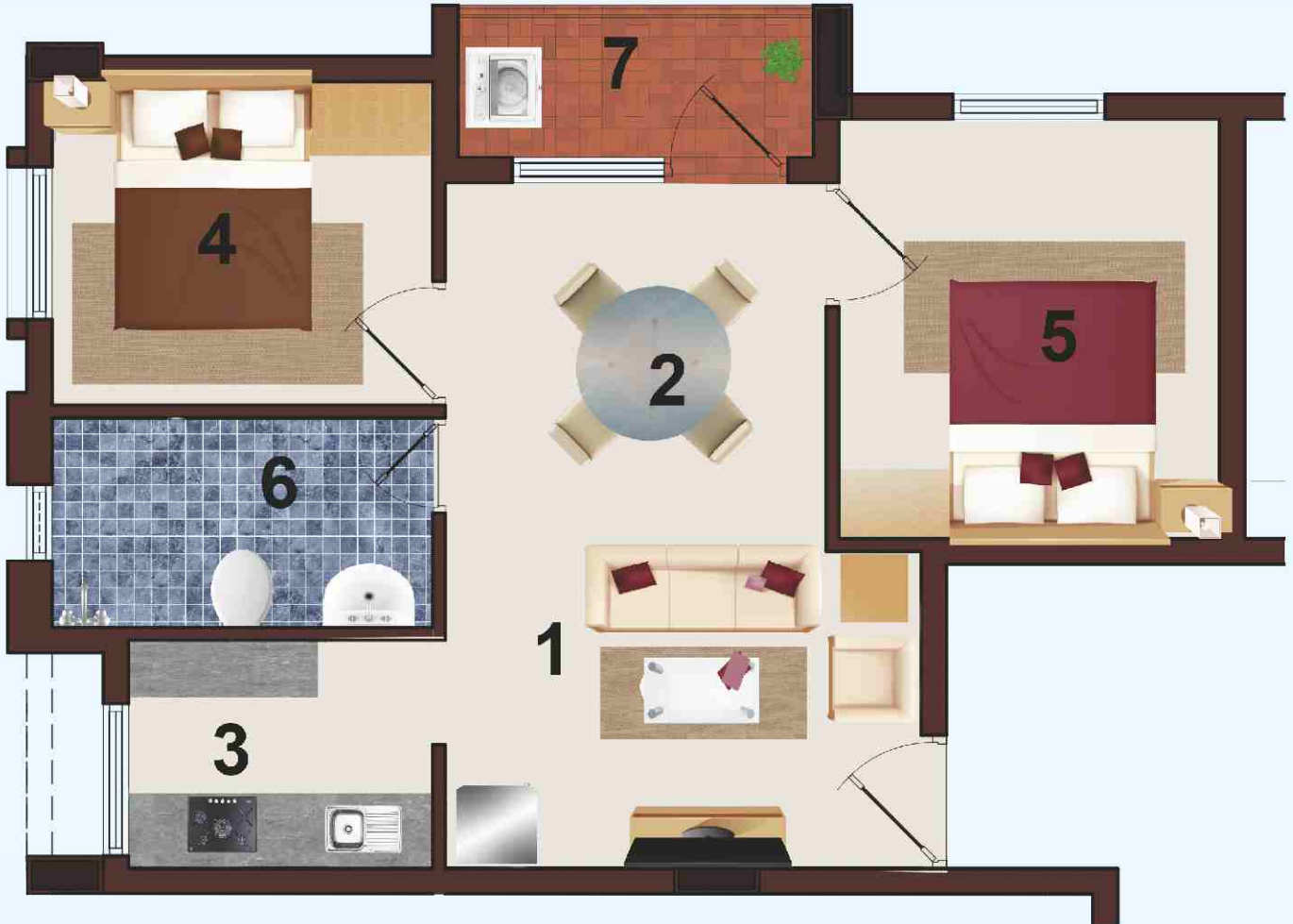

Flat No.	Carpet Area in Sq.ft	Balcony Area in Sq.ft	Common Area in Sq.ft	Sale Area in Sq.ft
103 to 403	508	34	148	766

- 1 - HALL - 12'6" x 8'4"
- 2 - DINING - 10'0" x 9'8"
- 3 - KITCHEN - 8'0" x 6'0"

- 4 - BEDROOM - 10'0" x 8'6"
- 5 - BEDROOM - 10'0" x 11'0"
- 6 - TOILET - 10'0" x 5'6"

- 7 - BALCONY - 4' WIDE



A, B, C BLOCK 2 BHK

104 to 404

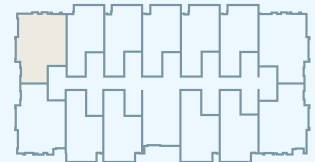

Flat No.	Carpet Area in Sq.ft	Balcony Area in Sq.ft	Common Area in Sq.ft	Sale Area in Sq.ft
104 to 404	508	34	148	766

DIMENSION

1 - HALL - 12'6" x 8'4"

2 - DINING - 10'0" x 9'8"

3 - KITCHEN - 8'0" x 6'0"

4 - BEDROOM - 10'0" x 8'6"

5 - BEDROOM - 10'0" x 11'0"

6 - TOILET - 10'0" x 5'6"

7 - BALCONY - 4' WIDE



A, B, C BLOCK 2 BHK

110 to 410

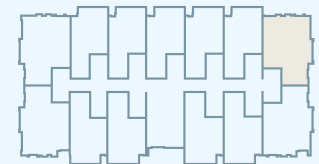

Flat No.	Carpet Area in Sq.ft	Balcony Area in Sq.ft	Common Area in Sq.ft	Sale Area in Sq.ft
110 to 410	508	34	148	766

DIMENSION

1 - HALL - 12'6" x 8'4"

2 - DINING - 10'0" x 9'8"

3 - KITCHEN - 8'0" x 6'0"

4 - BEDROOM - 10'0" x 8'6"

5 - BEDROOM - 10'0" x 11'0"

6 - TOILET - 10'0" x 5'6"

7 - BALCONY - 4' WIDE



A, B, C BLOCK 2 BHK

111 to 411

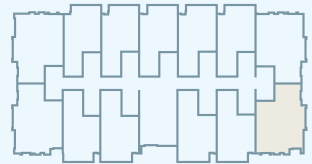

Flat No.	Carpet Area in Sq.ft	Balcony Area in Sq.ft	Common Area in Sq.ft	Sale Area in Sq.ft
111 to 411	508	34	148	766

DIMENSION

1 - HALL - 12'6" x 8'4"

4 - BEDROOM - 10'0" x 8'6"

7 - BALCONY - 4' WIDE

2 - DINING - 10'0" x 9'8"

5 - BEDROOM - 10'0" x 11'0"

3 - KITCHEN - 8'0" x 6'0"

6 - TOILET - 10'0" x 5'6"



E BLOCK 1 BHK

101 to 401 & 109 to 409

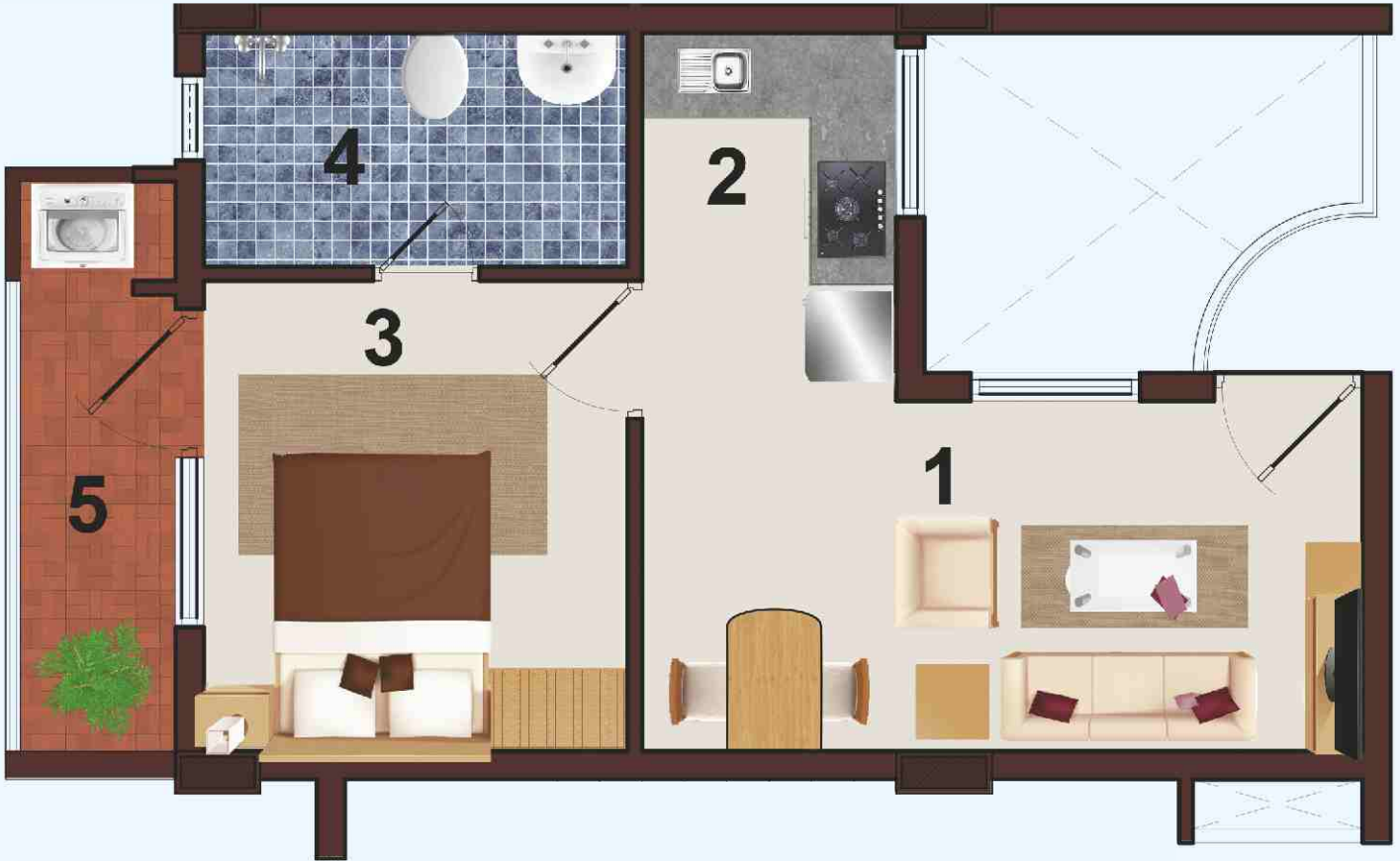

Flat No.	Carpet Area in Sq.ft	Balcony Area in Sq.ft	Common Area in Sq.ft	Sale Area in Sq.ft
101 to 401	365	47	130	605
109 to 409	365	47	130	605

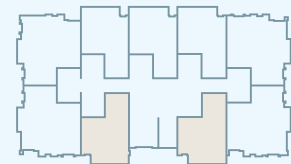

DIMENSION

1 - HALL / DINING - 17'0" x 8'3"

4 - TOILET - 10'0" x 5'6"

2 - KITCHEN - 6'0" x 8'8"

5 - BALCONY - 4' WIDE

3 - BEDROOM - 10'0" x 11'1"



E BLOCK 1 BHK

104 to 404, 105 to 405, 106 to 406



Flat No.	Carpet Area in Sq.ft	Balcony Area in Sq.ft	Common Area in Sq.ft	Sale Area in Sq.ft
104 to 404	365	47	130	605
105 to 405	365	47	130	605
106 to 406	365	47	130	605

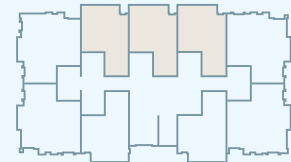

DIMENSION

1 - HALL / DINING - 17'0" x 8'3"

4 - TOILET - 10'0" x 5'6"

2 - KITCHEN - 6'0" x 8'8"

5 - BALCONY - 4' WIDE

3 - BEDROOM - 10'0" x 11'1"



E BLOCK 2 BHK

102 to 402

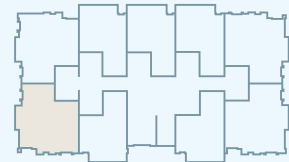

Flat No.	Carpet Area in Sq.ft	Balcony Area in Sq.ft	Common Area in Sq.ft	Sale Area in Sq.ft
102 to 402	510	34	170	789

DIMENSION

1 - HALL - 12'6" x 8'4"

2 - DINING - 10'0" x 9'8"

3 - KITCHEN - 8'0" x 6'0"

4 - BEDROOM - 10'0" x 8'6"

5 - BEDROOM - 10'0" x 11'0"

6 - TOILET - 10'0" x 5'6"

7 - BALCONY - 4' WIDE



E BLOCK 2 BHK

103 to 403

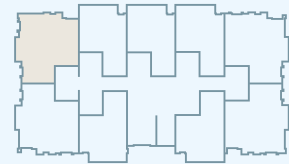
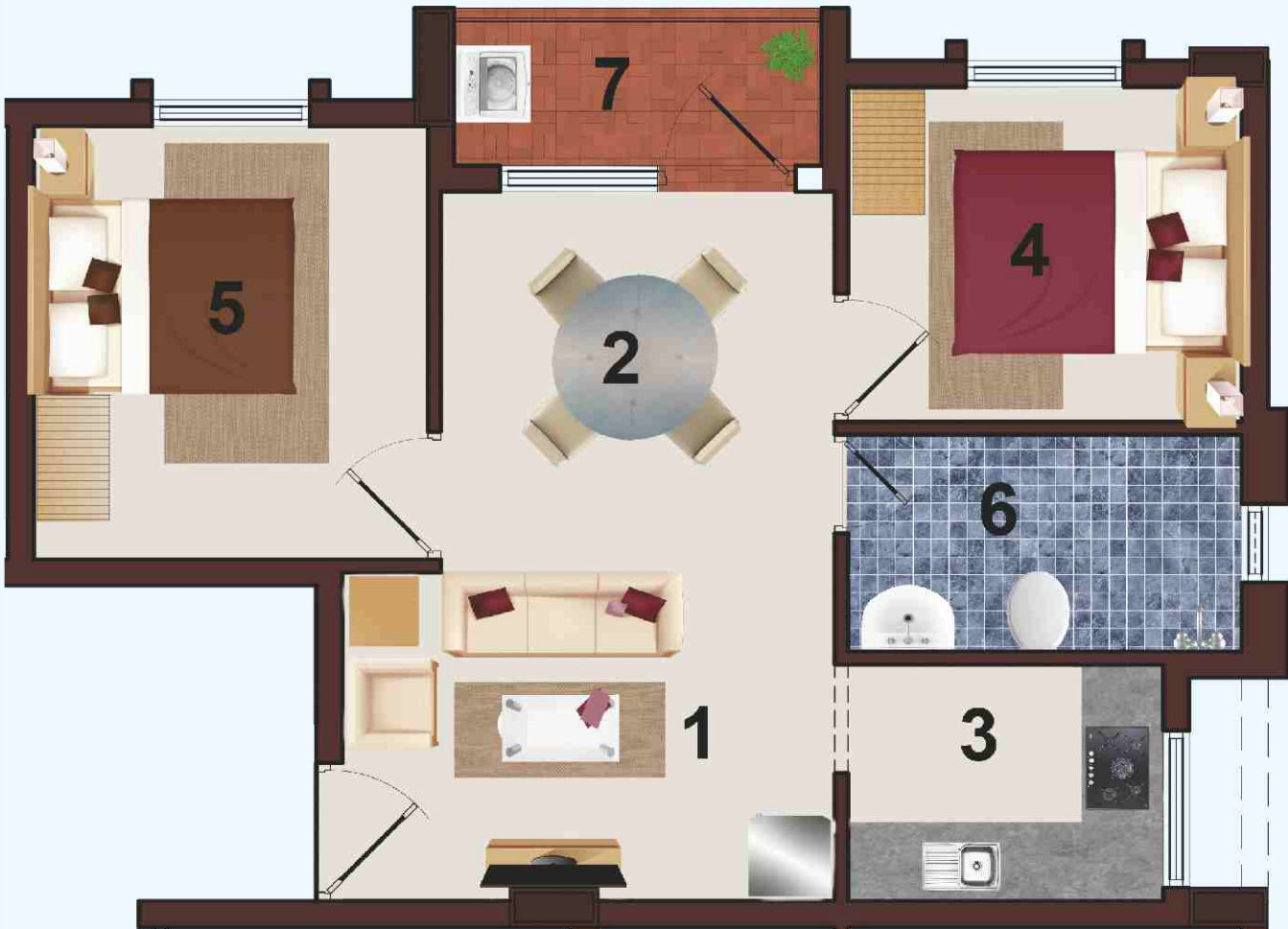

Flat No.	Carpet Area in Sq.ft	Balcony Area in Sq.ft	Common Area in Sq.ft	Sale Area in Sq.ft
103 to 403	510	34	170	789

DIMENSION

1 - HALL - 12'6" x 8'4"

4 - BEDROOM - 10'0" x 8'6"

7 - BALCONY - 4' WIDE

2 - DINING - 10'0" x 9'8"

5 - BEDROOM - 10'0" x 11'0"

3 - KITCHEN - 8'0" x 6'0"

6 - TOILET - 10'0" x 5'6"



E BLOCK 2 BHK

107 to 407

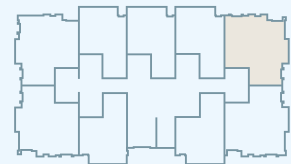

Flat No.	Carpet Area in Sq.ft	Balcony Area in Sq.ft	Common Area in Sq.ft	Sale Area in Sq.ft
107 to 407	510	34	170	789

DIMENSION

1 - HALL - 12'6" x 8'4"

4 - BEDROOM - 10'0" x 8'6"

7 - BALCONY - 4' WIDE

2 - DINING - 10'0" x 9'8"

5 - BEDROOM - 10'0" x 11'0"

3 - KITCHEN - 8'0" x 6'0"

6 - TOILET - 10'0" x 5'6"



E BLOCK 2 BHK

108 to 408

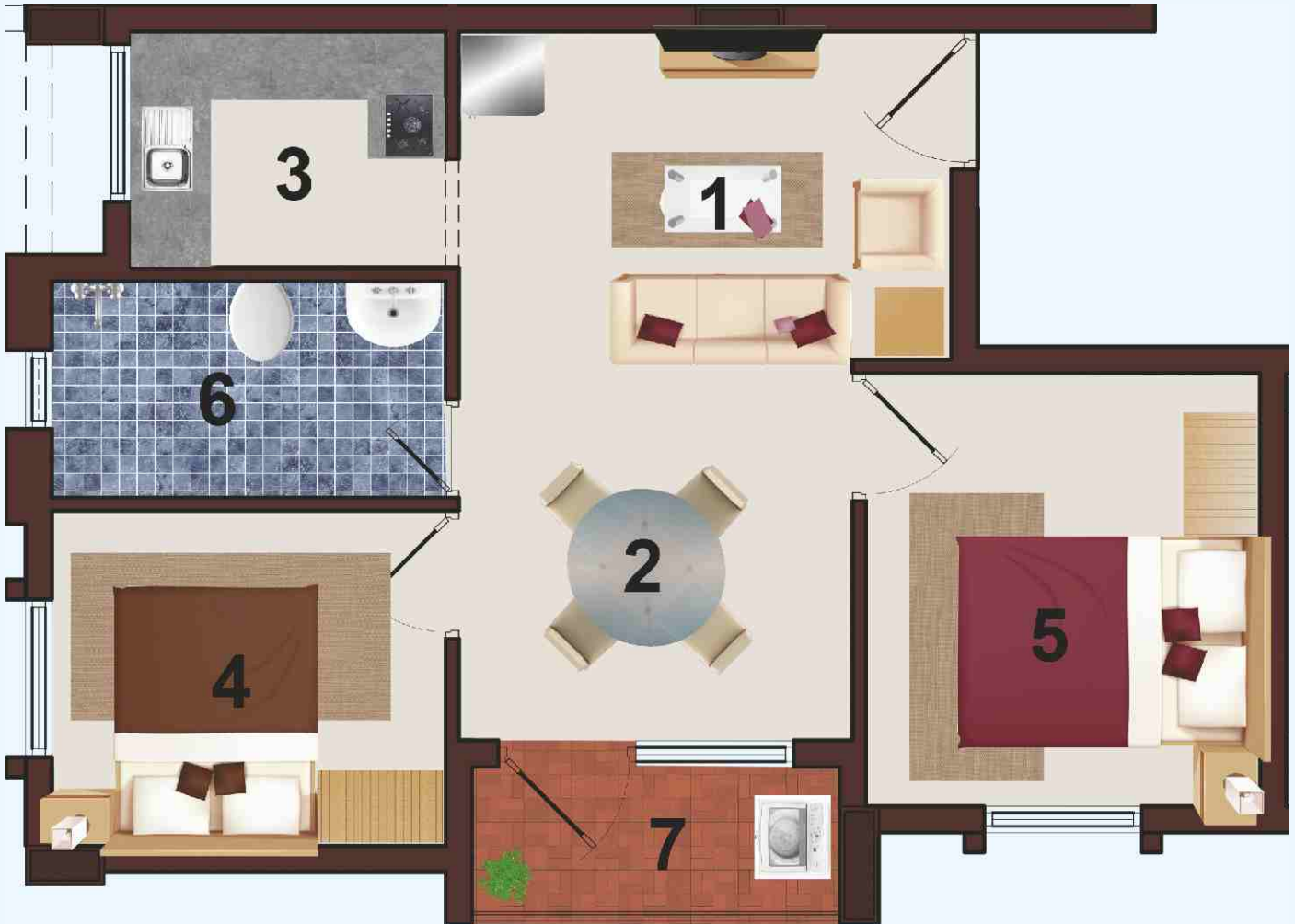

Flat No.	Carpet Area in Sq.ft	Balcony Area in Sq.ft	Common Area in Sq.ft	Sale Area in Sq.ft
108 to 408	510	34	170	789

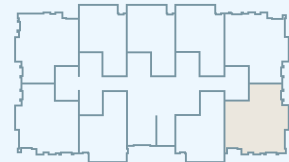

DIMENSION

1 - HALL - 12'6" x 8'4"

4 - BEDROOM - 10'0" x 8'6"

7 - BALCONY - 4' WIDE

2 - DINING - 10'0" x 9'8"

5 - BEDROOM - 10'0" x 11'0"

3 - KITCHEN - 8'0" x 6'0"

6 - TOILET - 10'0" x 5'6"

